

South Washington Street to Johnsons Mill Rd - TOWN OF BATH SIDEWALK EVALUATION

Street	Sidewalk Map No.	Corner Map Letter	Evaluated Condition Code	Condition Found (Missing Sections; warped; steps/drops; patches; <4 ft wide)	Complies w/ADA Stds?	Notes
	1, 2, 3 etc	A, B, C etc	G-Y-R	MS-W-S/D-P-<4'	Ramps/Material	Status in Streetscapes Plans

Overall Note for this Street: With the exception of the ADA ramps at Fairfax St, there are no painted cross-walks that cross

South Washington Street between Martinsburg Rd (Rte-9) and Johnsons Mill Rd

		A	Y	Ramps to driveway look OK; Traffic Signal Pole in S/W past Corner A	Partial	No DWS; Obstruction in S/W
South Washington	1		Y	Good to Fair S/W surface; 4 ft S/W narrows to 3 to 3-1/2 ft in spots - mostly due to vegetation encroachment. Build-up of dirt & stones narrows the S/W	Partial	Ramps on either side of lots & driveways generally OK; but no DWS and no crosswalks across So. Washington in this area
		C	G	Slight Ramp in line w/ sidewalk to be level with street crossing	Yes	Ramp appears to be fairly recent
		B	R	No Sidewalk; Curbs with Entrances to Sheetz; signpost obstruction; no DWS	No	Difficult intersection to cross; no S/W on either side of Rte 9; gas station paving on either side of Rte-9; No crosswalk
South Washington	2		Y	Starts @ end of Sheetz lot; Good to Fair S/W surface; 4 ft S/W narrows to 3 to 3-1/2 ft in spots - mostly due to vegetation encroachment.	Partial	Ramps on either side of lots & driveways generally OK; but no DWS and no crosswalks across So. Washington in this area
		D	G	Sidewalk essentially level with drive, no gaps or steps	Yes	Some cracking in driveway
		E	G	Slight Ramp in line with sidewalk to be level with street crossing	Yes	Ramp appears to be fairly recent
South Washington	3		G	Width appears to be at least 4 ft	Yes	Some erosion and small cracks, otherwise OK
		G	Y	Sidewalk made to be level with street crossing; S/W ends just across Coughlan Ln in a parking area	Partial	
		F	G	Sidewalk essentially level with drive, no gaps or steps	Yes	
South Washington	4		Y	Some steps & patches; narrows to 3-1/2 ft in places (vegetation)	Partial	
		H	Y	Sidewalk generally level with Johnsons Mill Rd	Partial	No DWS on either side of street crossing - no marked cross walk
		J	Y	Sidewalk level in places with Road; but some step and no DWS		No DWS; telephone pole at edge of S/W after Ramp
South Washington	6		Y	Sidewalk in generally Good Condition; basically looks like a 4 ft concrete S/W but narrowed in places to 3 ft due to vegetation encroachment	Partial	
		L	Y	Small added ramp (asphalt); Corner is first/only So. Washington St crossing	Partial	Signs designate this as a School Crossing to Broadway St; no DWS. Large drain just off S/W - creates trip hazzard

Note: Side of Street opposite S/W #6 has no Sidewalk. Road has whiole edge-paint and cars park off the pavement in this area

South Washington Street to Johnsons Mill Rd - TOWN OF BATH SIDEWALK EVALUATION

Street	Sidewalk Map No.	Corner Map Letter	Evaluated Condition Code	Condition Found (Missing Sections; warped; steps/drops; patches; <4 ft wide)	Complies w/ADA Stds?	Notes
	1, 2, 3 etc	A, B, C etc	G-Y-R	MS-W-S/D-P-<4'	Ramps/Material	Status in Streetscapes Plans

Identification & Coding of Sidewalks & Corners

Sidewalk Assessment by Streets & Blocks

Street: South Washington St (Martinsburg Rd (Rte-9) to Johnsons Mill Rd)

Key:
 Red Letters are Street/Sidewalk Corners
 Blue Numbers are Sidewalks along the Street

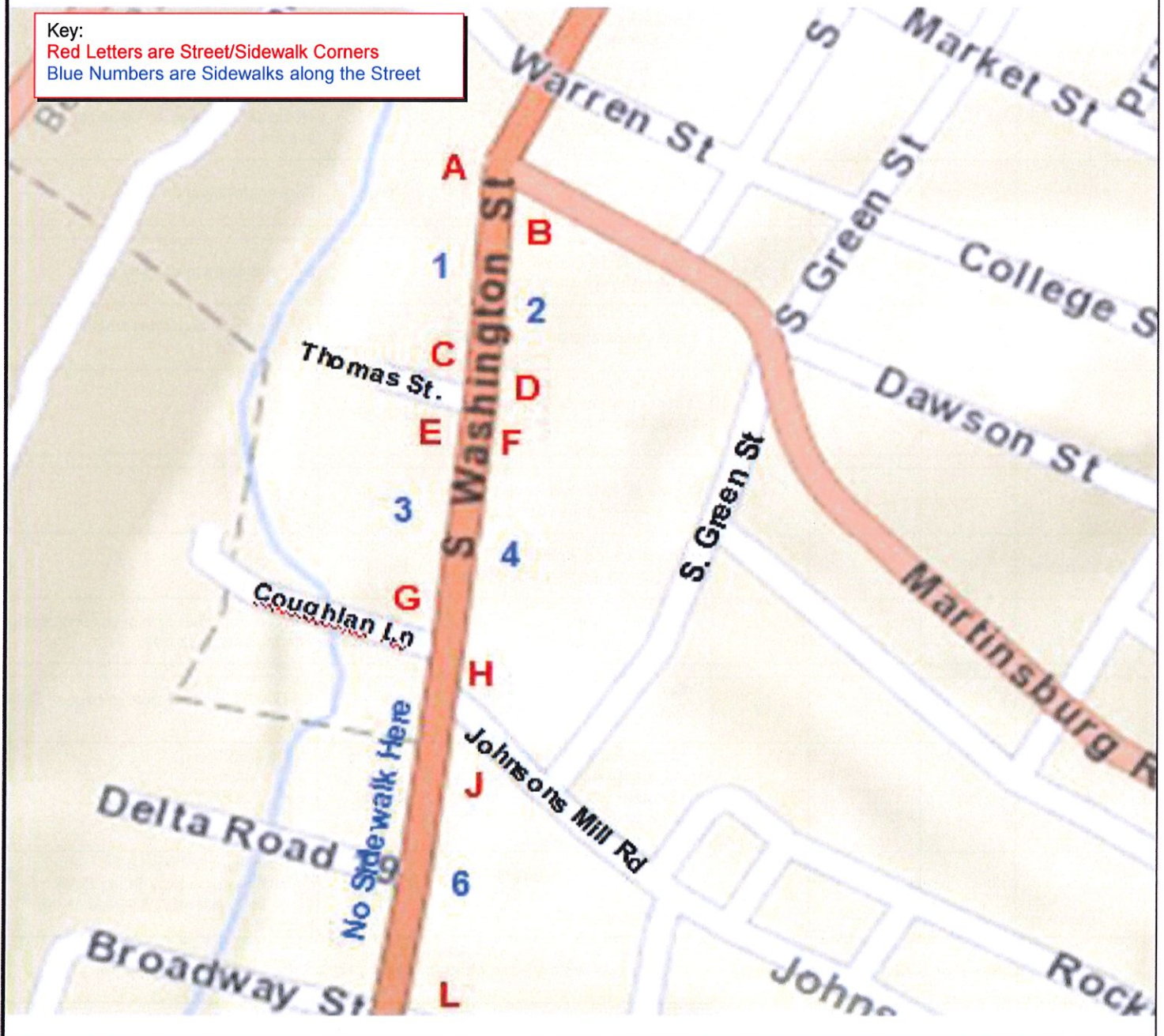

South Washington Street to Johnsons Mill Rd - TOWN OF BATH SIDEWALK EVALUATION

Street	Sidewalk Map No.	Corner Map Letter	Evaluated Condition Code	Condition Found (Missing Sections; warped; steps/drops; patches; <4 ft wide)	Complies w/ADA Stds?	Notes
	1, 2, 3 etc	A, B, C etc	G-Y-R	MS-W-S/D-P-<4'	Ramps/Material	Status in Streetscapes Plans

Color Coding of Results

Sidewalk Assessment by Streets & Blocks

Street: South Washington St (Martinsburg Rd (Rte-9) to Johnsons Mill Rd)

Color Coding of Results

Key:
 Red Letters are Street/Sidewalk Corners
 Blue Numbers are Sidewalks along the Street

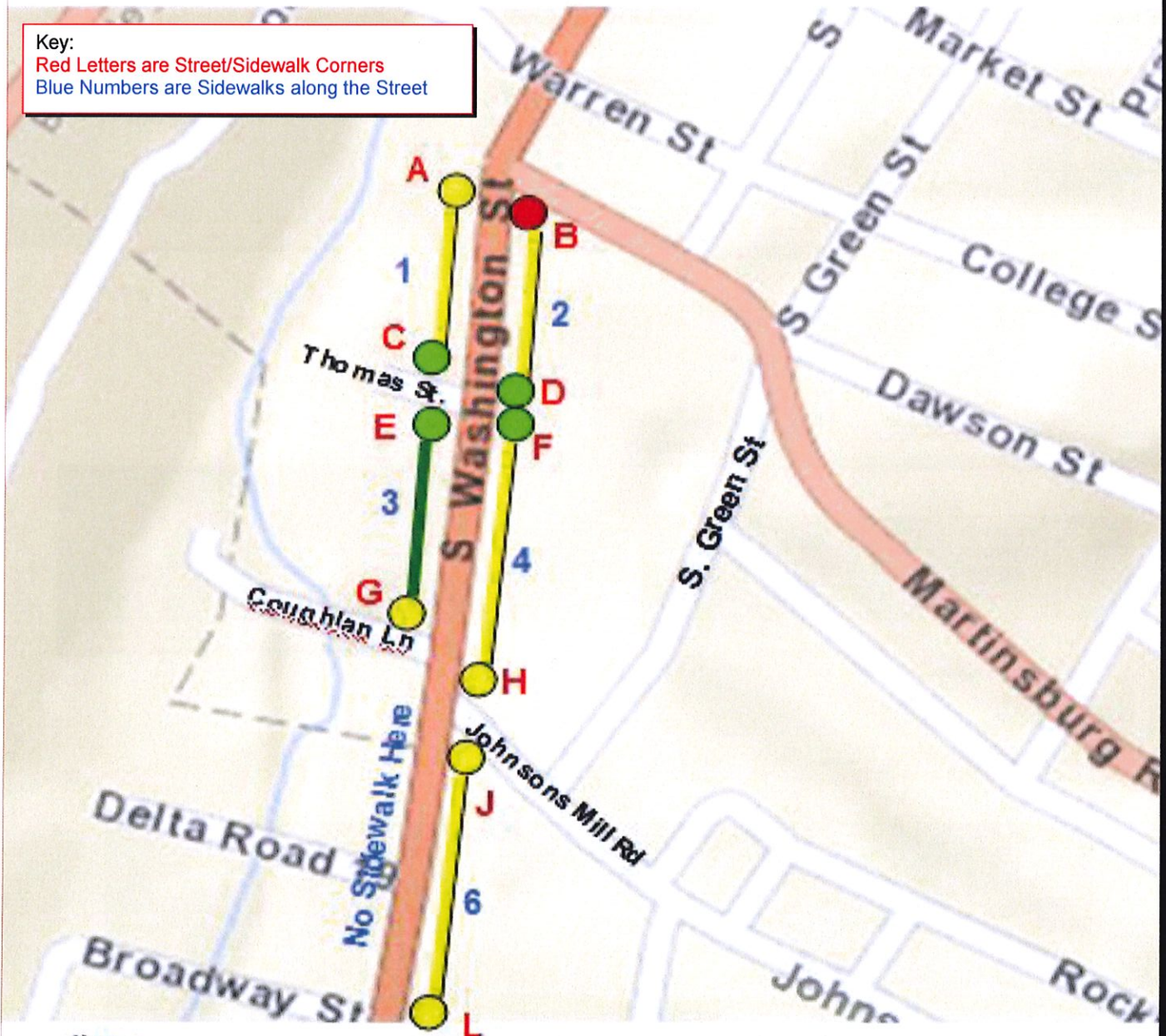

Key:
● Green – Near-new/new condition; meets ADA Criteria (also completed/Streetscapes Phase)
● Yellow – S/W & Corner with some patches/steps/erosion; serviceable; not fully up to ADA Criteria
● Red – Poor condition, materials; major patches, steps and drops; not ADA compliant

South Washington Street to Johnsons Mill Rd - TOWN OF BATH SIDEWALK EVALUATION

Street	Sidewalk Map No.	Corner Map Letter	Evaluated Condition Code	Condition Found (Missing Sections; warped; steps/drops; patches; <4 ft wide)	Complies w/ADA Stds?	Notes
	1, 2, 3 etc	A, B, C etc	G-Y-R	MS-W-S/D-P-<4'	Ramps/Material	Status in Streetscapes Plans

Some Photos of Specific Sidewalks & Corners

